

# Single Package Rooftop Units 12½ to 25 Tons Drip Edge Accessory

Cancels: New

IIK 551A-210-1  
6/1/05

## Installation Instructions

Part Number CRDRIPEG001B00

**IMPORTANT:** Read these installation instructions thoroughly **BEFORE** starting installation.

The accessory drip edge is used on the following units:

UNIT	SIZE
48/50HG	014-028
48/50HJ	020-028
48/50PG	20-28
551A/581A	210-300

### SAFETY CONSIDERATIONS

Installation and servicing of air-conditioning equipment can be hazardous due to system pressure and electrical components. Only trained and qualified service personnel should install, repair, or service air-conditioning equipment.

Untrained personnel can perform the basic maintenance functions of replacing filters. All other operations should be performed by trained service personnel. When working on air-conditioning equipment, observe precautions in the literature, tags and labels attached to the unit, and other safety precautions that may apply.

Follow all safety codes. Wear safety glasses and work gloves.

#### ⚠ WARNING

Before performing service or maintenance operations on unit, turn off main power switch to unit. Electrical shock could cause personal injury.

### GENERAL

Adding the accessory drip edge to the condenser and return ends of the unit allows for use of full perimeter base rail.

### PACKAGE CONTENTS

Check package contents for the correct parts as listed below.

PART NUMBER	QUANTITY	DESCRIPTION
50TG501260	1	Drip Edge (Return)
50TG501261	1	Drip Edge (Condenser)
—	1	Seal Strip (1/8 in. Thick x 3/4 in. Wide x 166 in. Long)

### INSTALLATION

Install the accessory using the following procedure.

#### ⚠ CAUTION

To avoid roof damage, be careful not to drop any sharp objects onto roof surfaces.

#### ⚠ CAUTION

When removing shipping rails, be careful not to drop rails onto roof surfaces or remove in a location where rails may fall causing personal injury.

1. Remove and discard shipping rails. Remove rails by removing the screws on each end of the unit. Save the screws.
2. Remove the additional screws from the ends of the unit as shown in Fig. 1. Save the screws.
3. Open the accessory kit and remove its contents.
4. Cut the seal strip into two equal length pieces and apply it to the screw hole edge of the two drip edges, as shown in Fig. 2.
5. Attach the return end drip edge to the return end of the unit using the screws from Step 2. The seal strip should be facing the unit, and the screws will go through it. Be sure to use screws in all locations to prevent water from leaking into the unit. (See Fig. 3.)
6. Attach the condenser end drip edge to the condenser end of the unit using screws from Step 2. The seal strip should be facing the unit, and the screws will go through it. Be sure to attach screws in all locations to prevent water from leaking into the unit. (See Fig. 3.)
7. Installation is now complete.

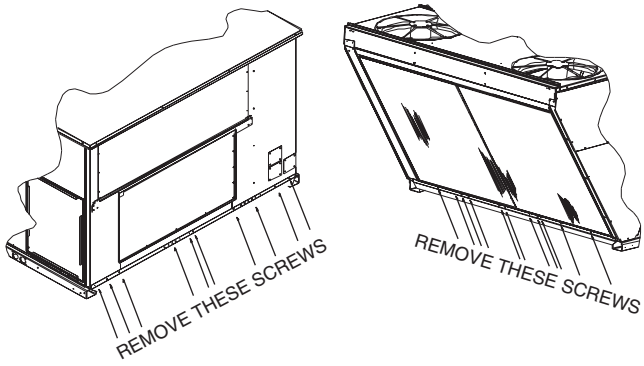

**Fig. 1 — Remove Screws**

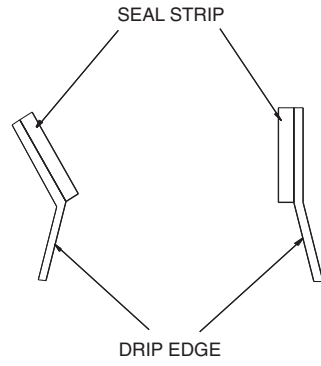

**Fig. 2 — Install Seal Strip**

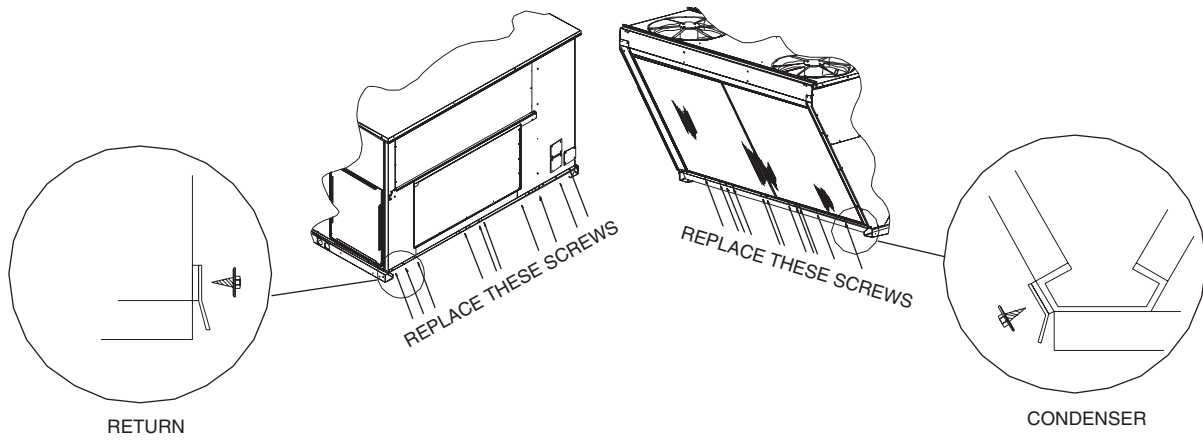

**Fig. 3 — Install the Drip Edges**