

Unit: inch

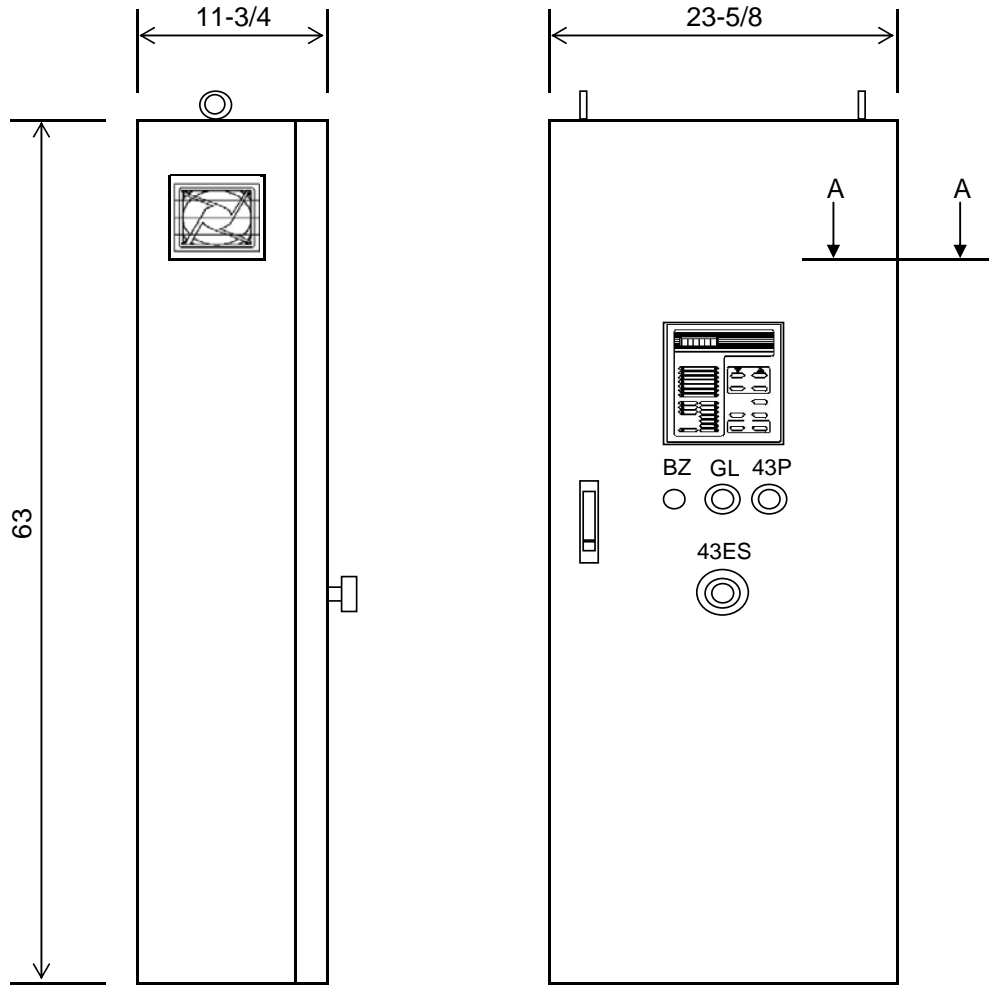

Section A-A

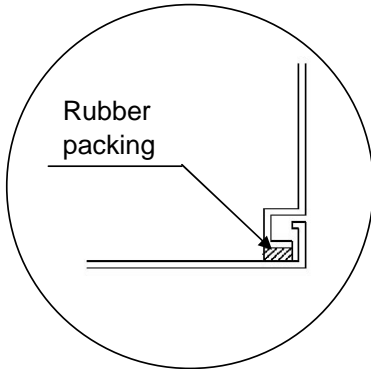

Power supply  
OD B

Remote control  
OD 7/8

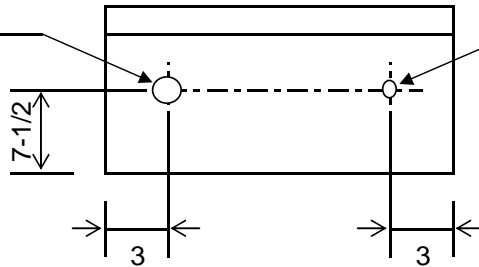

OD B: 1-3/8" for 16DJ-11 -- 42 (460V) & 16DJ11 -- 32 (208V)  
1-3/4" for 16DJ-41 -- 42 (208V)

Thickness : Body 0.08"  
Door 0.08"  
Mid plate 0.126"

Paint color : Munsel No.5Y7/1

Symbol	Name	Lamp color
BZ	Alarm buzzer	
GL	Purge indication lamp	Green
43P	Purge on-off switch	
43ES	Emergency stop button	

**Carrier**  
**SANYO**

**Control panel**

Model

**TSA-16DJ**

Drawing code

**CM-031-002-11-1**